



Retractable Hose Reel Owner's Manual

MODEL #520

ATTACH YOUR RECEIPT HERE

Liberty Garden™ Products

"Liberty" is a registered trademark of Liberty Garden Products, Inc. Kernersville, NC.
All Rights Reserved

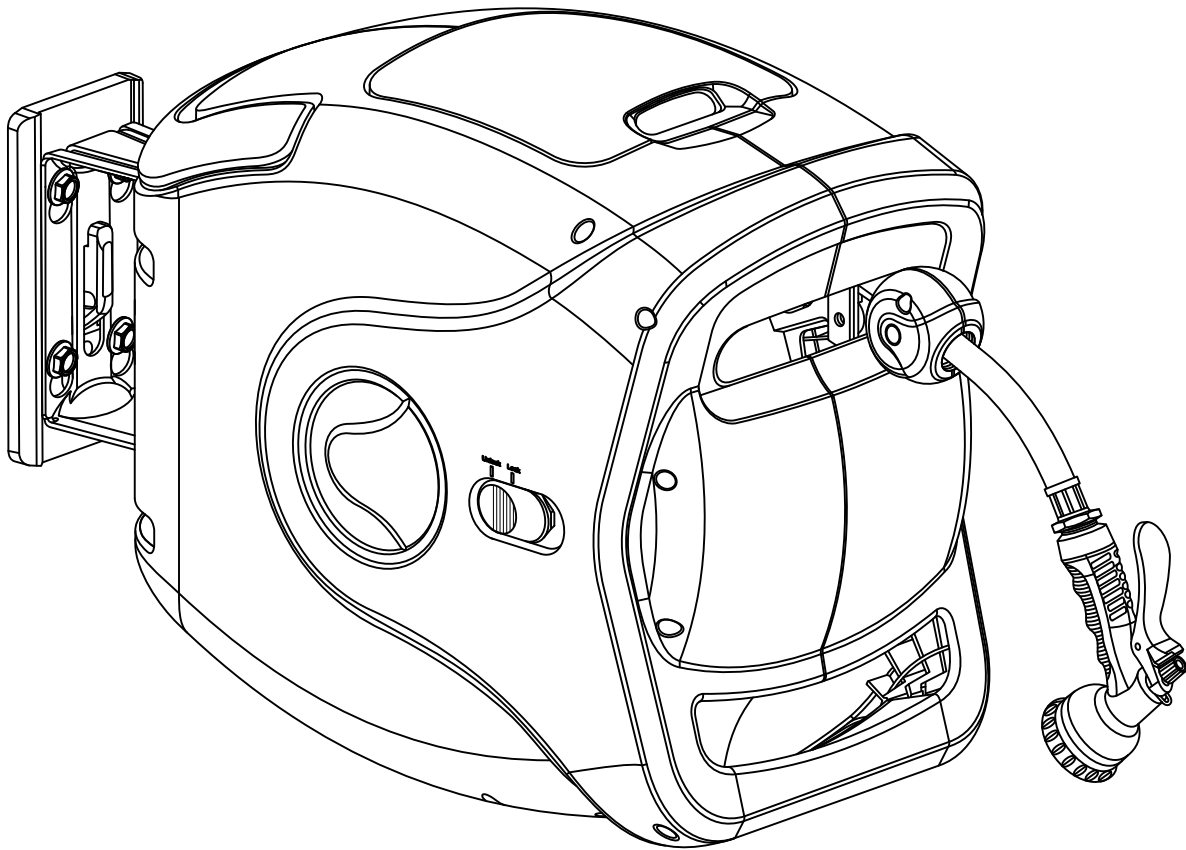

LIBERTY GARDEN™ PRODUCTS, INC.

1161 SOUTH PARK DRIVE, KERNERSVILLE NC 27284

Questions, problems, missing parts? Before returning the product to your retailer, call our customer service department toll free at 1-866-820-5805, 9 a.m. - 5 p.m., EST, Monday - Friday. You may also contact us at customerservice@libertygardenproducts.com

PRODUCT SPECIFICATIONS

SPECIFICATIONS
100' of 5/8" Hose Capacity
6' Leader Hose
Color: White and Gray
Made In China

SPECIFICATIONS
Height: 17.72"
Width: 12.01"
Length: 20.87"
Weight: 34.28 lbs

PACKAGE CONTENTS

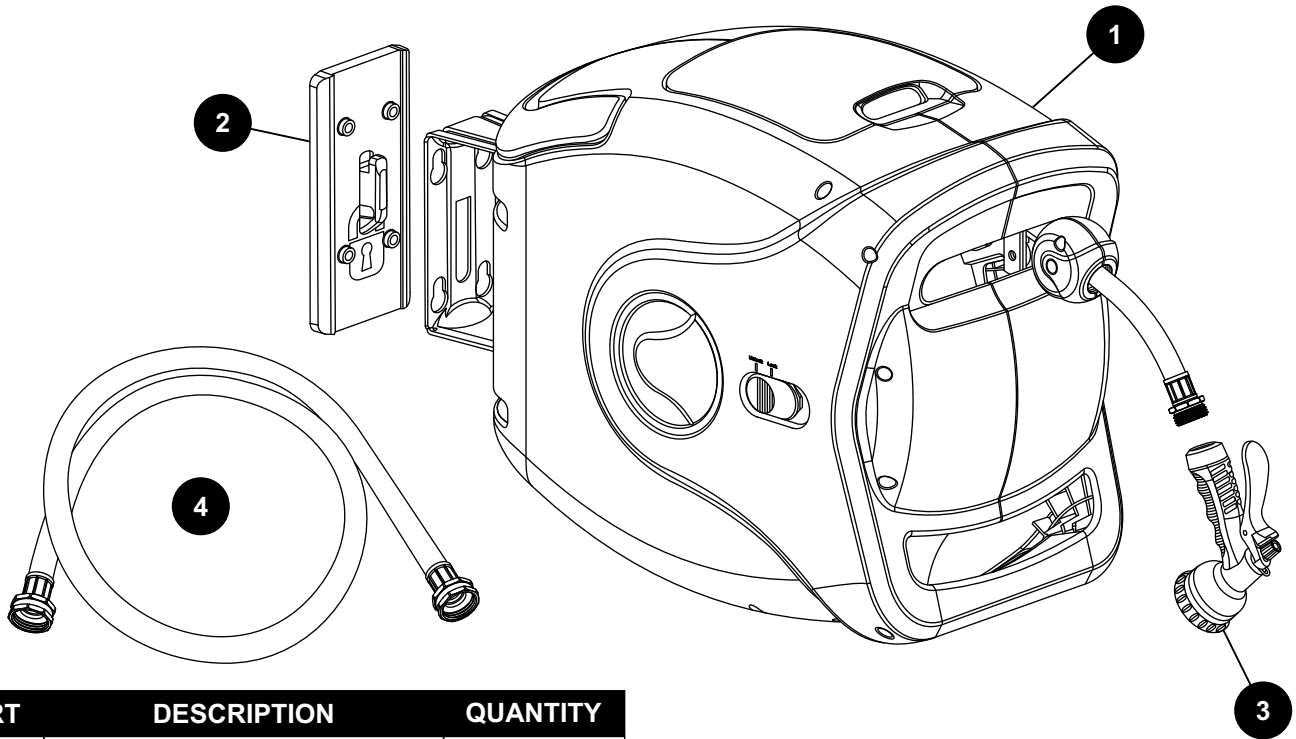

PART	DESCRIPTION	QUANTITY
1	Retractable Hose Reel	1
2	Wall Mounting Bracket	1
3	Spray Nozzle	1
4	Leader Hose	1

HARDWARE CONTENTS (Drawings are not to scale)

The hardware displayed below is included with the product.

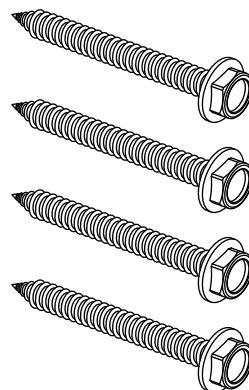
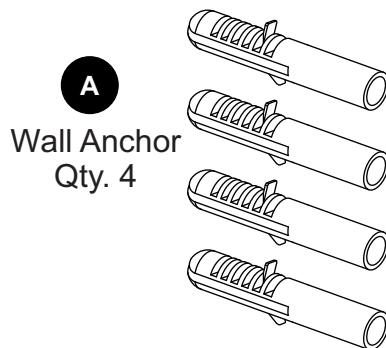

TOOLS REQUIRED FOR ASSEMBLY (Not Included)

Estimated Assembly Time: 10 minutes (not including mounting the hose reel).

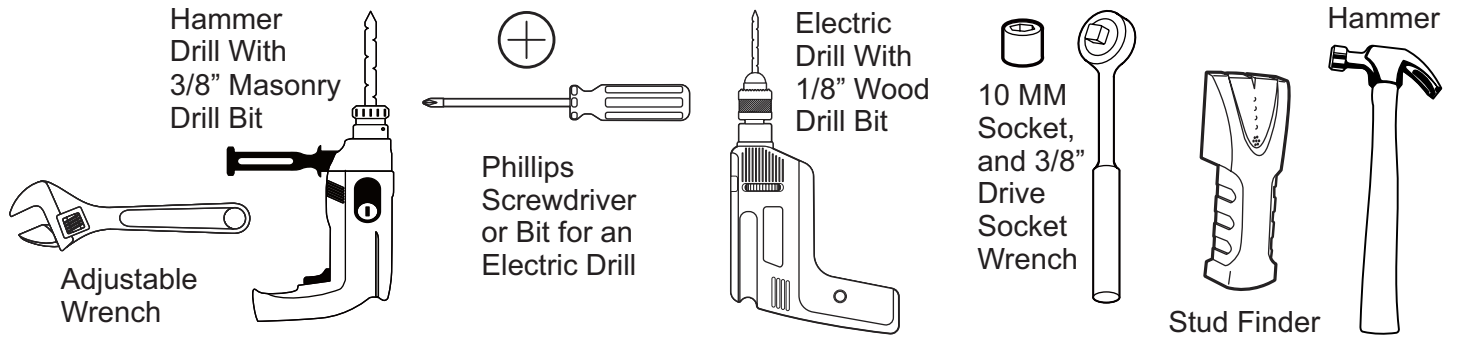

SAFETY INFORMATION

Please read and understand this entire manual before attempting to assemble, operate or install the product.

- **READ ALL INSTRUCTIONS CAREFULLY AND BE SURE THEY ARE FULLY UNDERSTOOD BEFORE USING THE HOSE REEL.**
- **DO NOT** load more than 100 feet of hose onto the reel.
- The retractable hose reel is designed for home watering applications using cold water only. It is not intended for commercial applications.
- **DO NOT** exceed maximum water pressure of 125 PSI.
- **DO NOT** expose the unit to freezing temperatures while water remains in the plumbing system. Freezing temperatures can cause damage to the unit. Drain water from the hose cart and store indoors during freezing temperatures.
- Before use, ensure the reel is securely attached to the wall and free of obstructions.
- **DO NOT** consume water from garden hose, it is not rated for human consumption.
- Do not place undue force on the reel casing. Doing so may damage the casing or the bracket.
- Children should not be allowed to operate or play with the retractable hose reel. Ensure children are clear of the hose and casing when unwinding.
- Always walk the hose back to the reel when rewinding.
- This product has a short break in period. If the hose does not retract all the way the first few attempts, please pull the hose all the way out and retract it again. The reel will retract easier after each use.
- When mounting the retractable hose reel, ensure it is secured to a supportive anchor. We recommend a 4 x 4 Post. If mounting to siding or stucco please ensure that it is secured to a 2 x 4 or 2 x 6 stud behind the wall to support the weight. For Brick & Mortar homes please use a masonry bit and wall anchors.



WARNING: This product can expose you to lead, which is known to the state of California to the state of California to cause cancer and birth defects or other reproductive harm. For more information, go to www.P65Warnings.ca.gov.

INSTALLATION INSTRUCTIONS

NOTE: The Retractable Hose Reel must be mounted to a solid masonry wall or to wall studs.

The following mounting hardware is recommended for the retractable hose reel installation, and is included:

- WALL ANCHORS
- WOOD MOUNTING SCREWS

TIP: Remember to use the included quantity of hardware to properly support the total weight of the unit. A standard 100' length of garden hose weighs approximately 15 lbs. Filled with water. The additional weight can exceed 20 lbs. Ensure the mounting hardware will support the combined weight of the unit, garden hose, and water.

WALL ANCHOR MOUNTING INSTRUCTIONS

1. Position and hold the wall mounting bracket (2) against the brick or masonry wall at a convenient height. Mark the position of each suspension hole on the wall.

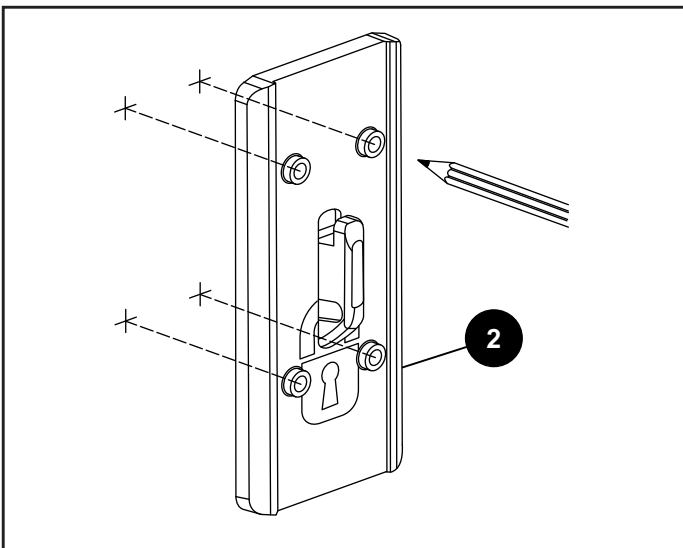

2. Remove the wall mounting bracket (2).
3. Using a hammer drill and 3/8" masonry bit, drill four holes at the marked positions on the wall.

NOTE: Ensure you drill the holes deep enough per wall anchor (A) manufacturers specifications.

4. Insert four wall anchors (A) into the drilled holes on the wall.
5. Using a hammer, lightly tap wall anchors (A) until they are fully seated in the wall.

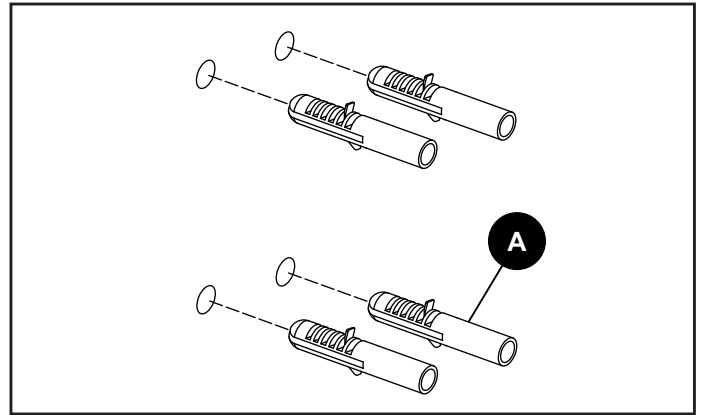

6. Position the wall mounting bracket (2) on the wall anchors (A).
7. Use a 10 MM socket and 3/8" drive socket wrench, or an electric drill and 10 MM nut driver to secure the four wall screws (B) and wall mounting bracket (2).

NOTE: DO NOT fully tighten the wall screws (B) at this time.

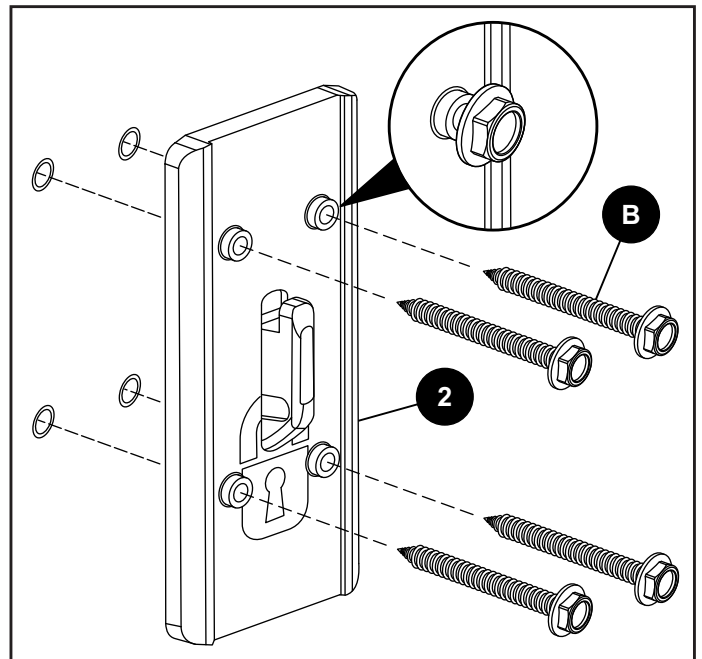

INSTALLATION INSTRUCTIONS (continued)

WOOD SCREW MOUNTING INSTRUCTIONS

1. Using a stud finder, locate the wood studs in the wall.
2. Position and hold the wall mounting bracket (2) against the wall at a convenient height. Mark the position of each suspension hole on the wall.

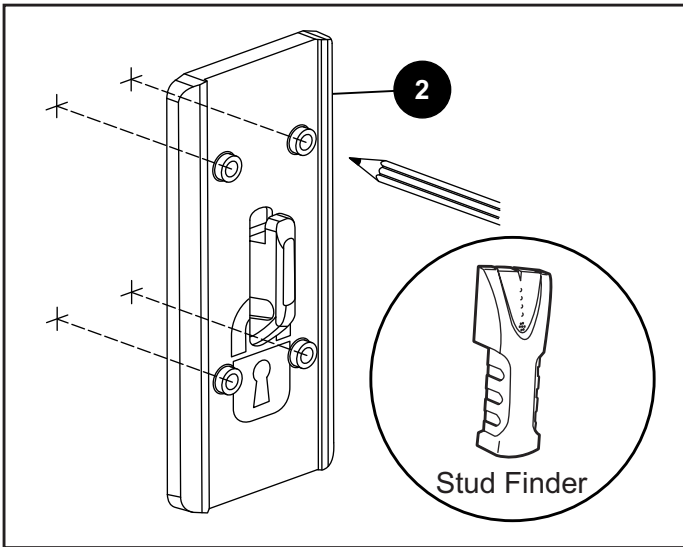

3. Remove the wall mounting bracket (2).
4. Using an electric drill with a 1/8" wood drill bit, drill four pilot holes at the marked positions on the wall.

5. Position the wall mounting bracket (2) on the pilot holes.
6. Use a 10 MM socket and 3/8" drive socket wrench, or an electric drill and 10 MM nut driver to secure the four wall screws (B) and wall mounting bracket (2).

NOTE: DO NOT fully tighten the wall screws (B) at this time.

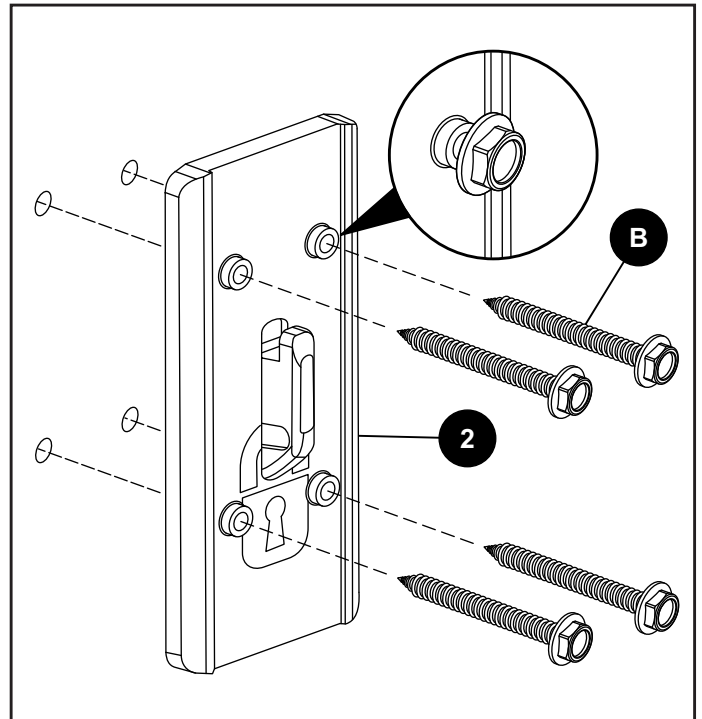

ASSEMBLY INSTRUCTIONS

1. With help, use the lift handle to hang the retractable hose reel (1), to the wall mounting bracket (2) and four wall screws (B). Tighten the wall screws (B) until they are snug against the metal bracket.

NOTE: DO NOT overtighten the screws.

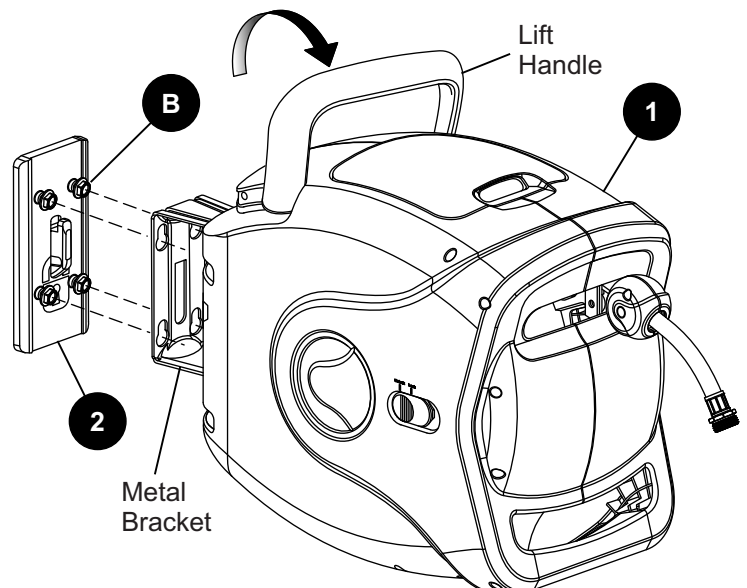

ASSEMBLY INSTRUCTIONS (continued)

2. Attach leader hose (4) to the male inlet on the bottom of the retractable hose reel (1).
3. Attach the other end of leader hose (4) to the water source. Rotate the hose reel 180° to ensure there is no strain from the water source to the reel.

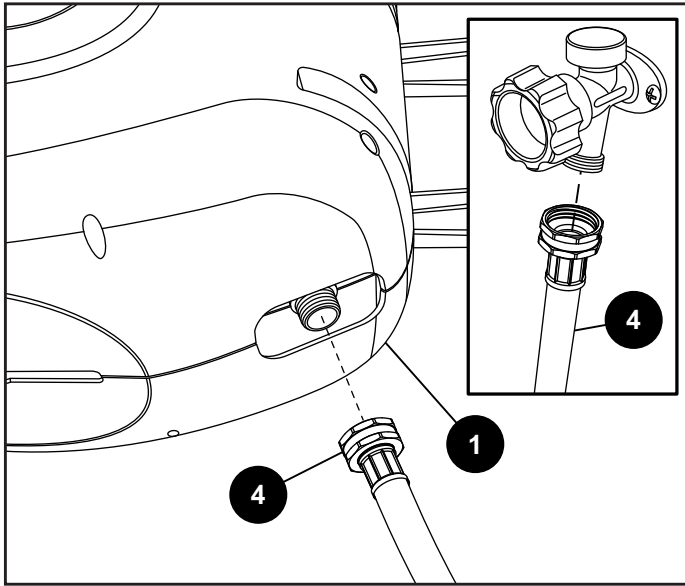

4. Install the spray nozzle (3).

NOTE: There is a hole located at the center of the wall mounting bracket, this hole is used to secure your retractable hose reel from theft. Use a preferred padlock (Not Supplied).

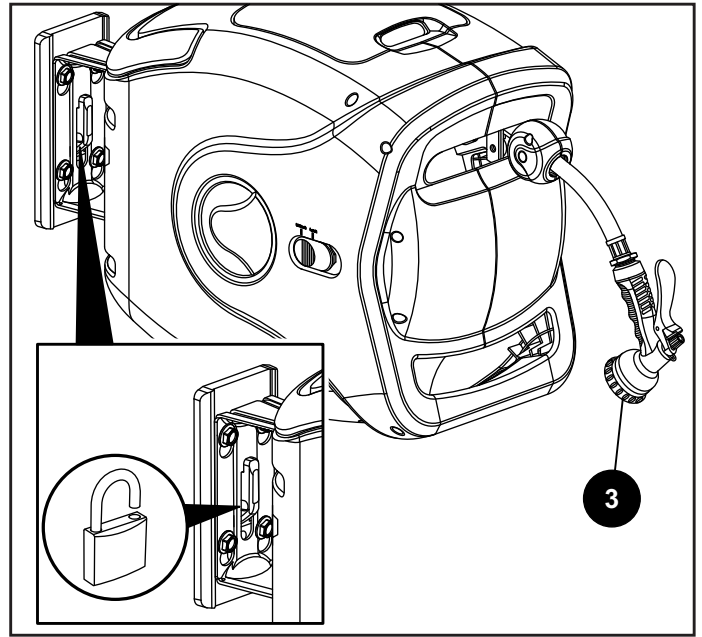

OPERATING INSTRUCTIONS

Now your retractable hose reel is securely mounted, connected to the water source, and is ready to use.

1. Before the first use, turn the water on at the tap and unwind the hose. The hose will unwind by simply taking hold of the hose and walking away from the reel. This will allow water to flow freely through the hose and reel.
2. The automatic locking ratchet will hold the hose in place at the desired length. The mechanism will “**CLICK**” as the hose is locked into place.
3. **NOTE:** Ensure the “Lock/Unlock” button is in the Unlock position to ensure proper function of the automatic locking ratchet.

4. To retract the hose, pull on the hose until you feel the reel release and start to retract the hose. It is recommended that you walk the hose back to the reel.

NOTE: Before walking back to the reel, release the water pressure in the hose (through the spray or nozzle). This will ensure full and even retraction of the hose.

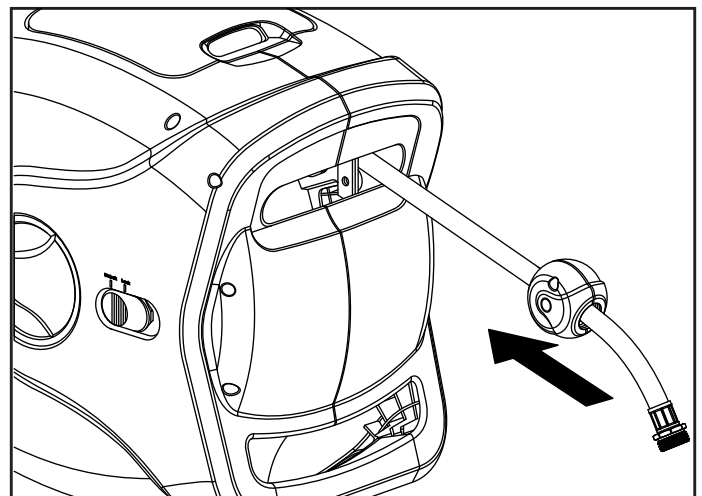

Warning: In order to retract the hose safely, please ensure you keep hold of the hose end while walking towards the hose reel. Letting go of the hose, may result in injury.

HOSE REPLACEMENT INSTRUCTIONS

1. Pull out all of the hose to the end and until it locks in place. Push the knob on the side of hose reel to the "**Lock**" position. Pull hose again to ensure the drum is locked properly.

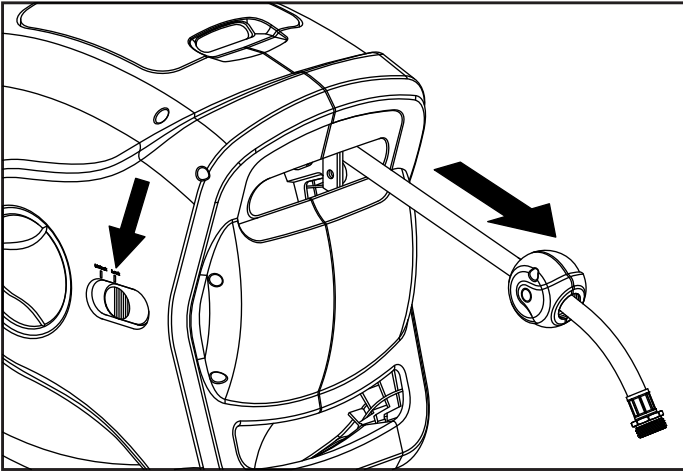

2. Open the top cover.

3. Unscrew the two screws before pulling out the connector.

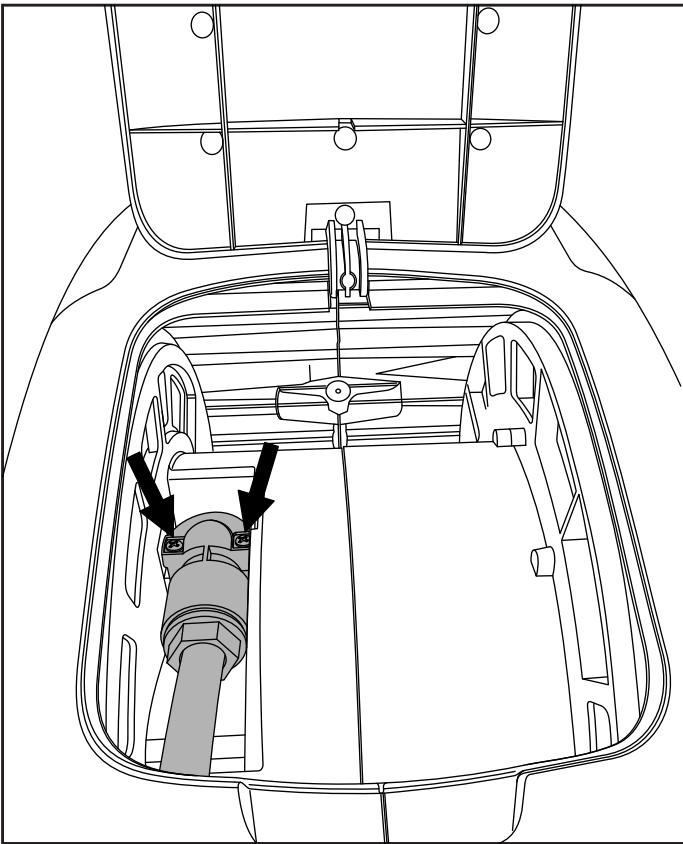

4. Unscrew the hose from the connector before pulling the hose out of the reel.

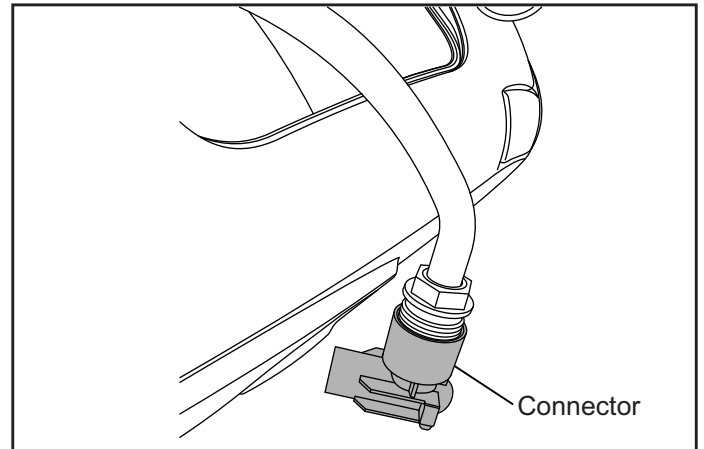

5. Remove the hexagonal nut and clamp from the damaged hose. Now, pull the damaged hose from the unit.

NOTE: Save the hexagonal nut and clamp for reuse on the replacement hose.

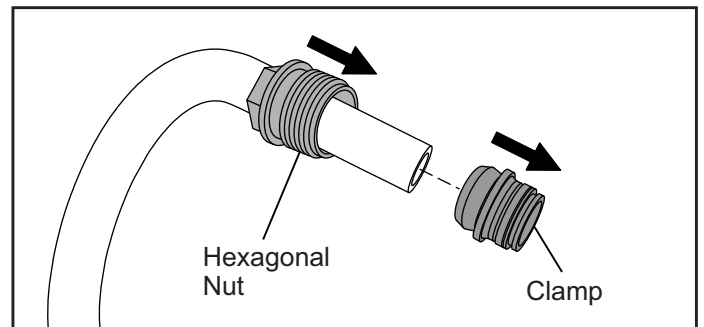

6. Using a utility knife, cut off the "**Female**" end of the replacement hose. Assemble the new hose, hexagonal nut, and clamp as shown in the figure below.

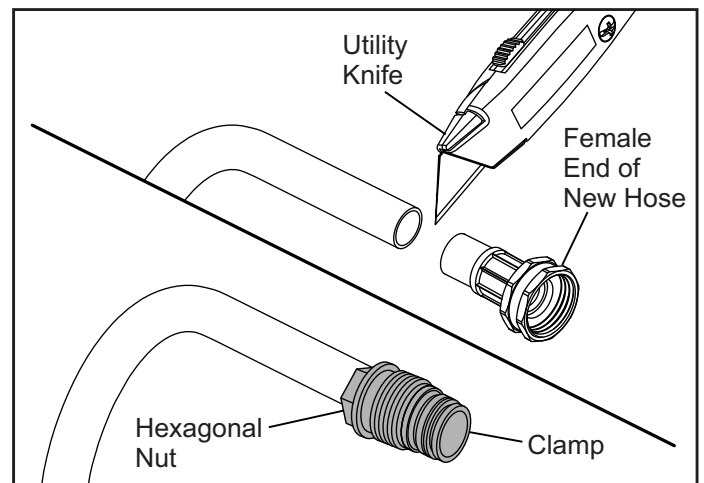

HOSE REPLACEMENT INSTRUCTIONS (continued)

7. Pull the assembled replacement hose through the opening of the unit and screw the connector to the end of the replacement hose.

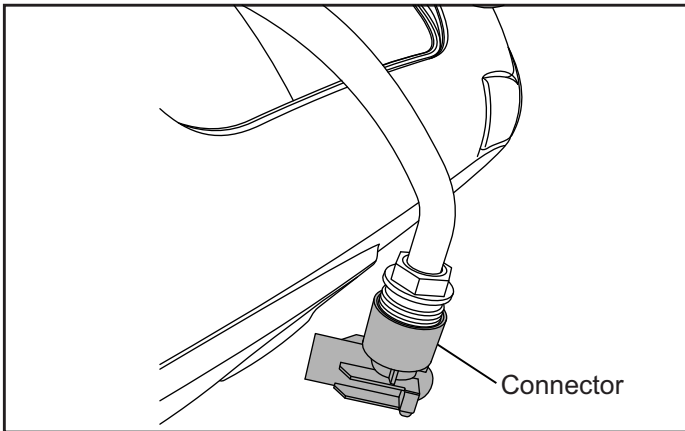

8. Position connector and hose assembly as shown in the figure below. Install the two previously removed screws securing the connector. Tighten the two screws to ensure the connector is fastened properly.

NOTE: Do Not overtighten screws.

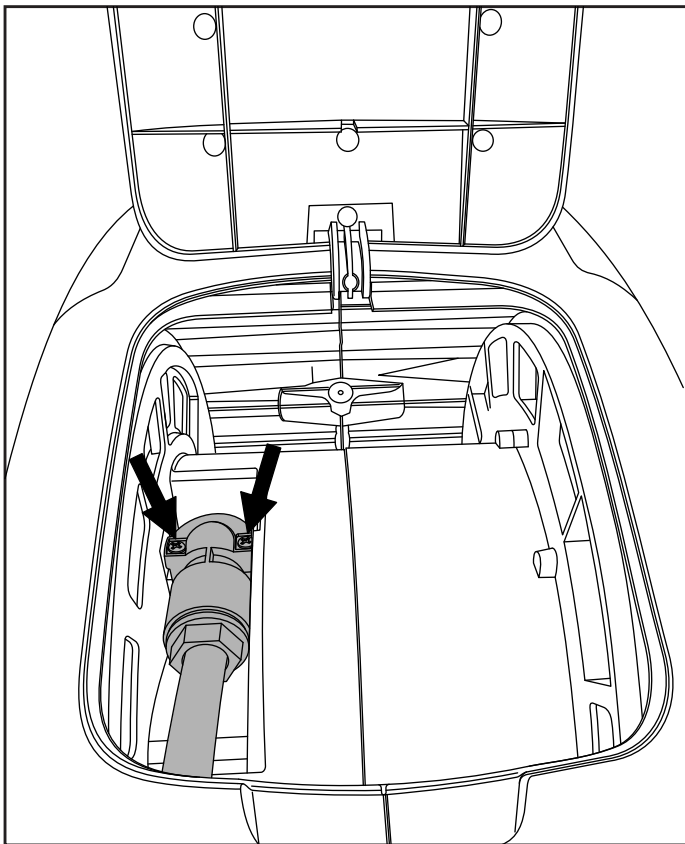

9. Close the cover. Using a Phillips screwdriver, remove the hose stopper from the damaged hose and place it on the new hose in the desired position. See figure below.

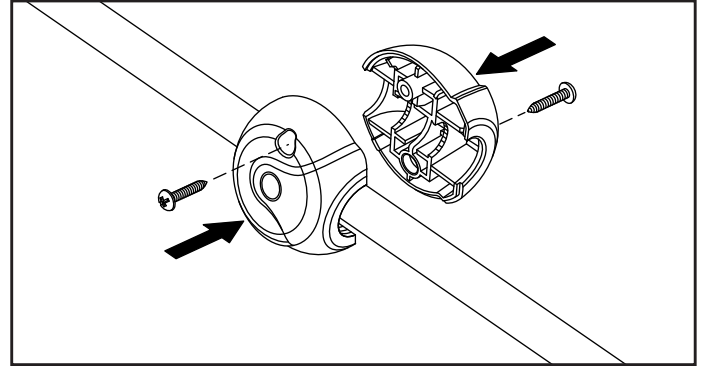

10. Push the knob on the side of the reel to the "Unlock" position. Give a slight pull on the hose to start retracting the hose. Hold the hose slightly until the hose is completely retracted.

11. Assemble the spray nozzle (3).

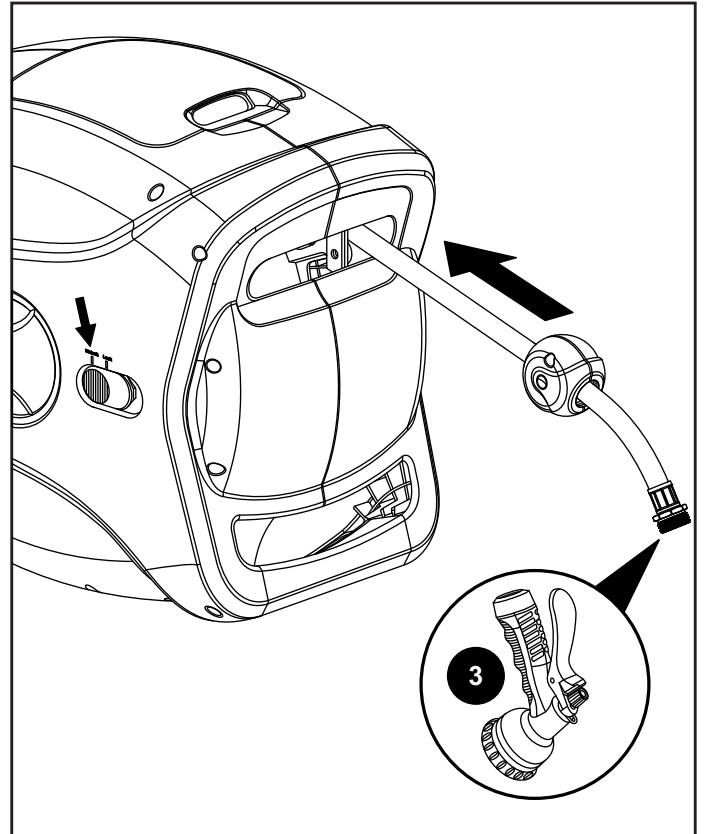

CARE AND MAINTENANCE

WINTERIZING AND STORAGE

Drain the hose reel prior to the onset of freezing temperatures. If any trapped water freezes, it may cause damage to the hose reel, hose, and even your pipes.

Store the entire unit - including hose reel and hose - inside your garage or storage shed at above-freezing temperatures. Storing your hose reel inside during the winter is an excellent way of protecting your garden hose, leader hose and spray nozzle.

When you install your hose reel, be sure the hose washers are in place and all fittings are secure. If you live in more temperate climates, be sure to drain the unit of any residual water before storing.

The hose reel includes a medium-duty hose. After use, turn off the water. Sunlight can heat the water and damage the hose, which will cause the hose to be difficult to rewind. Therefore, it is best to turn the water off before retracting the hose. **DO NOT** leave the reel outside in cold temperatures. **DO NOT** allow the hose to come in contact with any chemical substance, such as acetone, white spirits, lactic acid, etc.

- **DO NOT EXPOSE UNIT TO FREEZING TEMPERATURES** while water remains in the plumbing system, this can damage the hose connections.

- **DO NOT** immerse the hose reel in water to clean it.

Your retractable hose reel is manufactured with the finest quality components available. This product will give you many seasons of reliable and functional hose storage. All components in the product are manufactured to rigorous quality standards not common in other consumer grade hose reels available today. In the case of wall mounted reels, be sure to use stainless steel mounting hardware. We recommend that you periodically inspect your reel for any surface damage. **NOTE:** Liberty Garden plastic hose reels use ultraviolet light stabilizers in our plastic, but over time, the plastic color, depending on the **amount** of sunlight, can fade.

LIBERTY GARDEN PRODUCTS LIMITED WARRANTY

(Effective March 12, 2026)

This limited warranty is applicable to each original end-customer (hereinafter "Customer") purchasing the model 520 Retractable Hose Reel.

1. LIMITED WARRANTY; EXCLUSIVE REMEDIES:

1.1. LIMITED WARRANTY ON PRODUCTS: Company warrants solely to the original Customer that (a) the Structural Frame will be free from defects in materials and workmanship under normal use for a period of three (3) YEAR(S) from the date of original retail purchase, and (b) the Non-Frame Parts (which consist of the crank handle, water connections, leader hose and will be free from defects in materials and workmanship under normal use for a period of ONE (1) YEARS from the date of original retail purchase. Notwithstanding the foregoing, the colors and finishes of the Products may vary within a reasonable scope due to unavoidable color variations in different production batches, and such variations shall not constitute a material defect. This limited warranty is limited solely to the original Customer with proof of purchase and is not transferable.

1.2. THE WARRANTY: During a covered Product's limited warranty period, Company will, at Company's sole option and discretion, (1) repair the defective component or product without charge or (2) replace the defective component or product without charge.

1.3. The foregoing limited warranty is subject to the Customer's proper storage, transportation, handling and use of the Products as the same are defined within Company's then-current published guides and instructions for use and care. The limited warranty does not include defects due to normal wear and tear, abuse or misuse, mishandling, neglect, accident, fire, lightning, sunlight or other natural hazard, delivery or transportation damage, failure to follow applicable directions or instructions, or improper or inadequate cleaning, maintenance, care, repairs, modifications, or use beyond a Product's intended use. Please note that since the Structural Frame is made from plastic, fading may occur over time. As such, this limited warranty does not include color fading or defects due to the same.

LIBERTY GARDEN PRODUCTS LIMITED WARRANTY (continued)

1.4. LIMITED WARRANTY CLAIMS PROCEDURE: To obtain performance under this limited warranty, Customer shall notify Company in writing (to Liberty Garden Products, Inc., 1161 South Park Drive, Kernersville, NC 27284, Attn: Customer Service / Warranty Department), by email (to customerservice@libertygardenproducts.com), or by telephone (to (336) 992-3595) with a full description of the defect that is covered by warranty and a copy of the dated proof of purchase of the applicable product. Our warranty is limited to items purchased in new condition from authorized distributors.

- Company shall review each such claim and issue Customer a return merchandise authorization (“RMA”) in the event that the described defect or condition merits warranty review as determined by Company. Customers who have been issued a RMA shall, at Company’s election, return the covered item to the same physical address listed above for reporting initial claims. Company shall not accept any returned product without a RMA.
- Upon receipt, Company will evaluate the returned product(s) to determine if there is a warranty claim and, if so, how Company wishes to remedy the same. During a covered product’s respective limited warranty period, Company will, at Company’s sole and absolute option and discretion, (1) repair the defective component or product without charge or (2) replace the defective component or product without charge. Refunds are not available pursuant to this limited warranty.
- Customer is solely responsible for transportation of the covered product(s) to the Company for evaluation (if applicable and requested by Company). In the event that Company determines that a claim under this limited warranty is justified, Company shall be responsible for transportation of the repaired, corrected, replaced or exchanged product back to Customer. Customer shall be solely responsible for the transportation of any product back to Customer if Company determines that a claim under this warranty is not justified.
- Any repaired, corrected, replaced or exchanged Products shall be subject to the Limited Warranty set forth to the duration of the original limited warranty period as set forth in Section 1.1. and not for any extended duration, following their repair, correction, replacement or exchange.

1.5. IF A COMPANY PRODUCT DOES NOT CONFORM TO THESE LIMITED WARRANTIES, THE PURCHASER’S SOLE AND EXCLUSIVE REMEDY IS, AT COMPANY’S SOLE AND EXCLUSIVE OPTION, THE (1) REPAIR OF ANY DEFECTIVE PRODUCT OR COMPONENT PART OR (2) REPLACEMENT OF ANY DEFECTIVE PRODUCT OR COMPONENT PART. THE LIMITED WARRANTY AND REMEDIES SET FORTH ABOVE ARE EXCLUSIVE AND MADE IN LIEU OF ALL OTHER WARRANTIES, REMEDIES, RIGHTS OR CONDITIONS, WHETHER ORAL OR WRITTEN, EXPRESS OR IMPLIED, EITHER IN FACT OR BY OPERATION OF LAW, STATUTORY OR OTHERWISE, INCLUDING THE IMPLIED WARRANTIES OF MERCHANTABILITY AND FITNESS FOR A PARTICULAR PURPOSE. COMPANY SPECIFICALLY DISCLAIMS, WITHOUT LIMITATION, ANY AND ALL OTHER WARRANTIES, EXPRESS OR IMPLIED, OF ANY KIND. IF COMPANY CANNOT LAWFULLY DISCLAIM IMPLIED WARRANTIES UNDER THIS LIMITED WARRANTY, ALL SUCH WARRANTIES, INCLUDING THE IMPLIED WARRANTIES OF MERCHANTABILITY AND FITNESS FOR A PARTICULAR PURPOSE, ARE LIMITED IN DURATION TO THE DURATION OF THIS LIMITED WARRANTY. The Company does not assume or authorize any person to assume for them any other liability in connection with the Products.

2. EXCLUSION AND LIMITATION OF LIABILITY:

IN NO EVENT, WHETHER BASED ON CONTRACT OR TORT OR OTHER LEGAL THEORY, SHALL COMPANY BE LIABLE FOR ANY INDIRECT, INCIDENTAL, PUNITIVE, SPECIAL OR CONSEQUENTIAL DAMAGES, INCLUDING BUT NOT LIMITED TO, DAMAGES TO OTHER PROPERTY, INCONVENIENCE, DAMAGES FOR LOSS OF PROFITS, REVENUE, GOODWILL OR USE, INCURRED BY CUSTOMER OR ANY THIRD PARTY, WHETHER IN AN ACTION IN CONTRACT, TORT, STRICT LIABILITY, OR IMPOSED BY STATUTE, OR OTHERWISE, EVEN IF ADVISED OF THE POSSIBILITY OF SUCH DAMAGES. Some states do not allow the exclusion or limitation of incidental or consequential damages or exclusions or limitations on the duration of implied warranties or conditions, so the above limitations or exclusions may not apply to Customer. In jurisdictions that limit the scope of or preclude limitations or exclusion of remedies or damages, or of liability, such as liability for gross negligence or willful misconduct or do not allow implied warranties to be excluded, the limitation or exclusion of warranties, remedies, damages or liability set forth above are intended to apply to the maximum extent permitted by applicable law. This limited warranty gives the Customer specific legal rights, and the Customer may also have other rights that vary by state, country or other jurisdiction.

3. SEVERABILITY:

If any provision of this limited warranty is held to be illegal, invalid or otherwise unenforceable, such provision will be enforced to the extent possible consistent with its stated intention, or, if incapable of such enforcement, will be deemed to be severed and deleted from this limited warranty, while the remainder of the terms of this limited warranty will continue in full force and effect.

4. DISPUTE RESOLUTION:

This Liberty Garden Products, Inc. Limited Warranty shall be governed by and construed in accordance with the laws of the State of North Carolina, without regard to its principles of conflicts of law. The parties acknowledge the exclusive jurisdiction of the federal and state courts of the State of North Carolina. Any claims or disputes under this Liberty Garden Products, Inc. Limited Warranty shall be heard exclusively in any state or federal courts sitting in Guilford County, North Carolina, and both parties expressly consent to the personal jurisdiction and venue of the North Carolina state and federal courts for such actions.



Liberty Garden Products

"Liberty" is a registered trademark of Liberty Garden Products, Inc. Kernersville, NC. All Rights Reserved 2026

Updated 03/12/2026